



**TOPCON**

*Delivery  
Systems*





## ***Pinnacle Delivery System***

The most versatile delivery system available is ready for any practice. The unique and innovative Pinnacle can be configured as either a space saving one-sided system or a traditional two-sided configuration with standard features that will create a smooth patient examination from start to finish. Ergonomically engineered modular components make the Pinnacle an easy choice for the progressive office.



## ***Omni-2DU Delivery System***

This cost-effective system offers maximum time and space efficiencies with unmatched accessibility to the patient. This one-sided (either right or left-hand) configuration encompasses all examination requirements in one attractively priced system. The Omni-2DU has the one-sided feature rich delivery that is recognized as the standard of efficiency.





## ***Benefits Of Thinking One Sided***

- **Integrated System**  
Integrates All Your Instrumentation & Controls To "Your" Writing-Hand Side
  - **Easy Patient Access**  
The One-Sided System Allows You To Have A Dual Refracting Lane And Minor Surgery Suite
  - **Huge Space Savings**  
Full-Lane Examination System Can Fit In Any Exam Room 8' x 9' Or Even Smaller
  - **Face-To-Face Communication**  
Everything You Need Is On Your Writing-Hand Side, Never Lose Eye Contact With Your Patient
  - **Time-Saver**  
Minimizing Refraction Time With Minimal Effort
  - **Reduces Fatigue**  
With Everything Within Arm's Length, Exams Can Be Performed From A Seated Position
  - **Wheelchair Accommodation**  
Instrument Arms With Extensive Range Allows Wheelchair Patients To Be Easily Examined
  - **Vast Array of Color Combinations**  
Many Color Combinations To Coordinate With The Dé cor Of Your Office
- Customized To "Your" Preferences, Because We Don't All Think Alike***
- **Versatility**  
Customizable With Loads Of Optional Accessories To Best Suit Your Needs....The Pinnacle Is Also Available As A Two-Sided System, If Preferred
  - **Optional Pinnacle Dual-Delivery Arm**  
Dual-Tabletop Offers Quick Delivery Of Slit Lamp With Any Combination Of A Keratometer, Auto-Refractor Or Flat-Screen Monitor For Slit Lamp Imaging

### ***Pinnacle***

- Full Auto-Switch Technology For Room Lighting Automation
- Counter-Balanced Arms With One-Position Locking Levers
- Three Rechargeable Wells
- Trial Lens Drawer
- Indirect Hanger And Overhead Lamp Are Standard
- Wide Range Of Optional Accessories Including Dual Arm, Overhead And Sink Cabinets, Fixation Targets And Numerous Other Accessories
- Accepts The Space Saving MC-3 Mirrored Chart Projection System
- Wheelchair Accessible (Please consult your tax advisor for complete ADA tax credit details)

### ***Omni-2DU***

- Manual Switch Electronics
- Counterbalanced Arms With One-Position Locking Levers
- Three Rechargeable Wells
- Trial Lens Drawer
- Overhead Lamp
- Wide Range Of Optional Accessories Including Overhead And Sink Cabinets, Fixation Targets And Numerous Other Accessories
- Wheelchair Accessible (Please consult your tax advisor for complete ADA tax credit details)

## Pinnacle Features

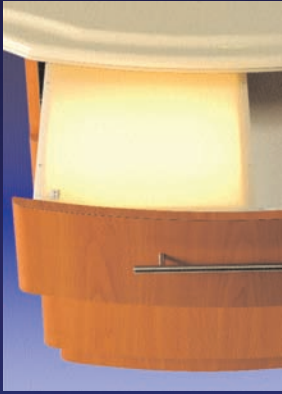

X-Ray Viewer



Overhead Cabinet  
With Task Light

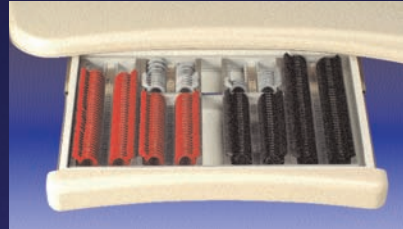

Trial Lens Drawer



File Storage

## Professional Performance

Auto Switch Electronics  
With Remote Control



Sink Cabinet



Hands Free Faucet



Projection Screen  
With Fixation Targets



## Omni-2DU Features



Manual Switch Electronics

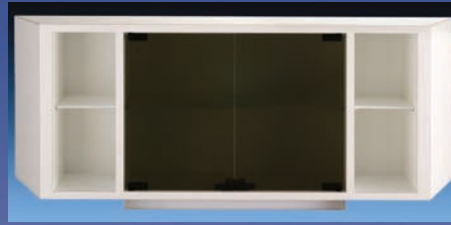

Overhead Cabinet  
With Task Light

## Practical Efficiency



Sink Cabinet

X-Ray Viewer



Rechargeable Wells



Storage Cabinet



## ***Signature Series Chairs And Stands***



The Topcon Chair and Stand family incorporates a modern appearance with a myriad of innovative features. There are three models of "Signature Series" chairs and two stands to choose from – Manual-Recline (OC-2200), Auto-Recline (OC-2300) and Motorized-Tilt (OC-2400), Auto and Manual type stands (IS-2000) and (IS-2500).

### **A Modern Look**

The IS-2000 is our latest example of offering every feature needed in an instrument stand while providing a fresh new look to update your exam lane!

### **Motorized Slit Lamp Arm**

The main arm on the IS-2000 is motorized with two speeds and two memory positions. This saves time and energy for fast and easy positioning.

### **Full Autoswitch Functions**

The IS-2000 also integrates with your room lighting. An optional integrated indirect hanger, that controls the room lights, is also available.

### **Hand-Held Remote Control**

For added convenience, the room lighting, fixations and chair controls can be adjusted from ANYWHERE IN THE ROOM!

### **Wheelchair Accessibility**

Our studies show that this is the most accommodating stand built today! 12" stroke of the upper arm allows an extensive range! Ergonomics and functionality are a priority in the design. (Please consult your tax advisor for complete ADA tax credit details).

## ***EXAM-3000 Compact Delivery System***

This ultra-modern design fits comfortably into a space saving 6' x 7' room. The EXAM-3000 "Power Desk" meets the working requirements of today's busy practitioner or technician demanding optimum performance in a small space. The Automatic MC-3 Mirrored Chart Projector creates a 20' refracting distance within the length of the desk unit.

Easy access to all instruments eliminate reaching. A unique powered arm and rotating slit lamp / auto refractor delivery highlights the ergonomic design.





## Exam Chairs



**OC-2200**



**OC-2300**



**OC-2400**

The Signature Series chairs offer patient comfort, flexibility and style, from the notched base for easy access with stool castors to the multi-position headrest that can even be positioned as a backrest for children.

Three types of recline styles are featured: OC-2200 manual-recline; OC-2300 auto-recline with memory positioning and auto return; and OC-2400 auto-tilt for a more compact setting requiring a 9" clearance behind the chair.



**OC-2100**



**OC-210**

The medium duty electric lift chairs allow simple and economical function for secondary offices and auxiliary lanes and pre-test areas that require patient positioning.

## Stools



**05-100**



**05-200**



**05-300**



**05-400**

Four different stools are available to fit your needs. The Signature Stools have premium castors that perform well on almost any surface. An extended pneumatic lift has a range of 8". The durability of this quality selection will provide many years of service.



## IS-2000 Stand Features



Powered Lower Arm



Remote Control

Programmable  
Charging Wells



Indirect Hanger



## ALL NEW IS-2500 Stand



The All New IS-2500 Instrument Stand is the latest addition in Topcon's family of delivery products. This easy to operate system features a single lock lever for both the slit lamp, and vision tester arm, as well as a thoughtful ergonomic design for a less stressful examination experience. From the standard electronics, to the progressive look, this stand is sure to fit the needs of your practice. Mate this innovative stand with any of our Signature Series chairs to complement the outstanding style and value for a truly impressive chair and stand package.



Console

Arm







Topcon Medical Systems, Inc. • 37 W. Century Rd. • Paramus, NJ 07652  
800-223-1130 • Fax: 201-634-1365 • [www.topcon.com](http://www.topcon.com)